

NE 1/4 SEC 27, TWP 20N, RGE 15E, W.M.

**CONCEPTUAL LAYOUT OF FUTURE PHASE,  
SUBJECT TO CHANGE (TYP)**

SCALE: 1" = 100'  
0 50 100 200

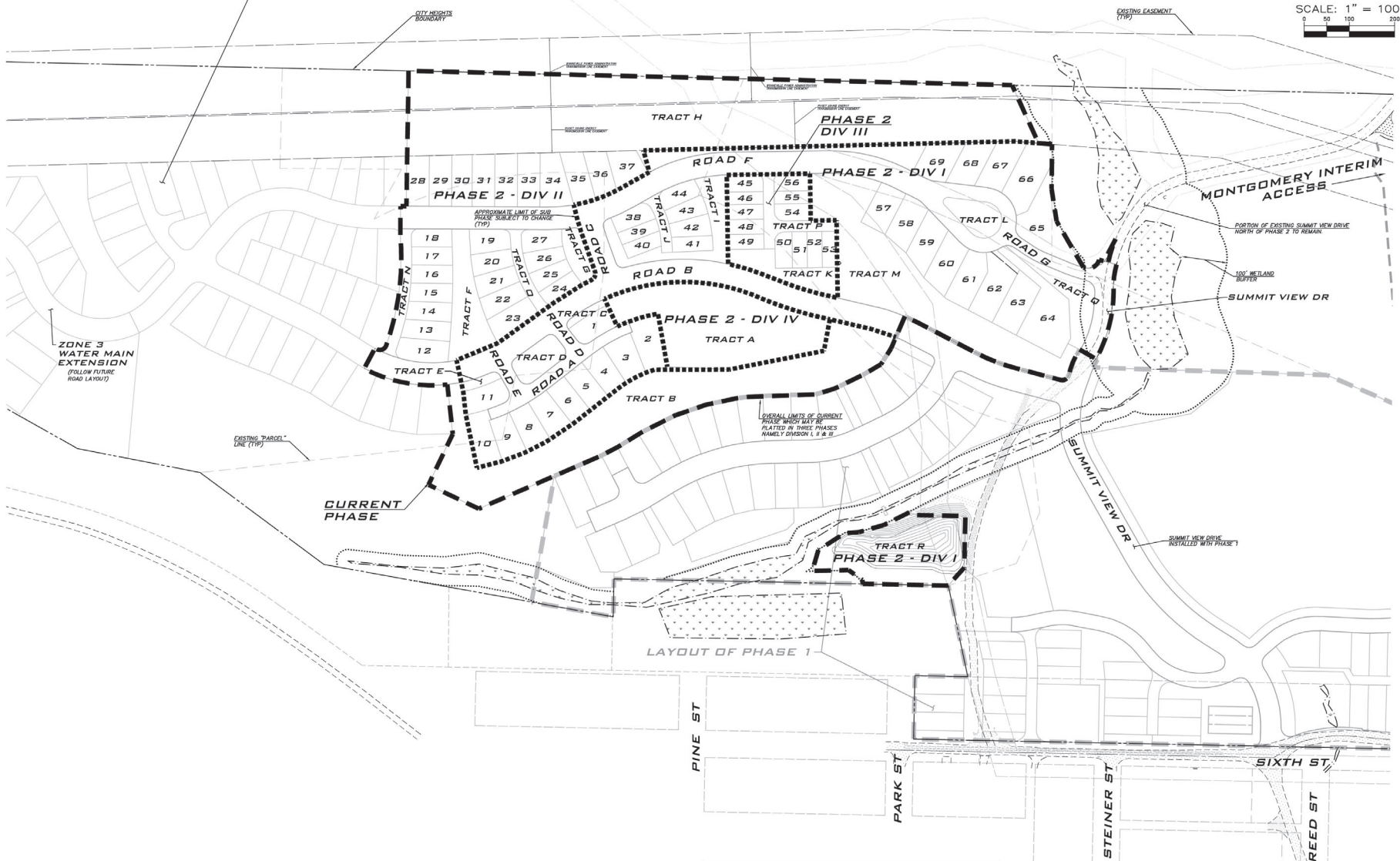

**PHASING NOTES**

- APPROVED DA CONTEMPLATED SITE TO BE DEVELOPED IN PHASES.
- LIMITS OF CURRENT PHASE SHOWN COVERS DEVELOPMENT PODS B4, B5 & B6.
- CURRENT PHASE MAY BE PLATTED IN SUBPHASES (DIV I, II, III & IV) AT DEVELOPER'S DISCRETION PROVIDED EACH SUBPHASE PROVIDES ADEQUATE INFRASTRUCTURE. ROADWAY PHASING SHALL MAINTAIN ACCESS TO ADJACENT PROPERTIES. IF SUB PHASES ARE PROPOSED THEY WILL BE DETERMINED PRIOR TO FINAL PLAT.
- REFER ALSO TO PHASING NARRATIVE MEMO PREPARED BY BLUELINE DATED 3/11/2022.

**EXISTING UTILITY NOTE**

EXISTING UTILITIES ARE SHOWN IN THE APPROXIMATE LOCATION. THERE IS NO GUARANTEE THAT ALL UTILITY LINES ARE SHOWN, OR THAT THE LOCATION, SIZE AND MATERIAL IS ACCURATE. THE CONTRACTOR SHALL UNCOVER ALL INDICATED PIPING WHERE CROSSING, INTERFERENCES, OR CONNECTIONS OCCUR PRIOR TO TRENCHING OR EXCAVATION FOR ANY PIPE OR STRUCTURES. TO DETERMINE ACTUAL LOCATIONS, SIZE AND MATERIAL THE CONTRACTOR SHALL MAKE THE APPROPRIATE PROVISION FOR PROTECTION OF SAID FACILITIES. THE CONTRACTOR SHALL NOTIFY ONE CALL AT 8-1-1 (WASHINGTON1.COM) AND ARRANGE FOR FIELD LOCATION OF EXISTING FACILITIES BEFORE CONSTRUCTION.

**BLUELINE**

25 CENTRAL WAY, SUITE 400  
BETHESDA, MD 20814  
P: 410.274.4651 F: 410.274.6042  
WWW.BLUELINEGROUP.COM

SCALE: AS NOTED

PROJECT MANAGER:  
**BRETT K. PLOSTIS, PE**

PROJECT ENGINEER:  
**LINDSEY EDZAK, PE**

DESIGNER:  
**CHRIS WISCOMB**

ISSUE DATE:  
**3/11/2022**

NO.	DATE	BY	REVISIONS
1	03/11/22	EW	REVISED FOR CITY COMMENTS

**PHASING MAP**

**CITY HEIGHTS**

**PHASE 2 (PODS B4, B5 & B6)**

(PRELIMINARY SITE PLAN & ENGINEERING)

CITY OF OLE ELUM WASHINGTON

3/11/22

JOB NUMBER:  
**19-349**

SHEET NAME:  
**PH-01**

BHT **6** OF **43**